

# GENUINE SYSTEM CARRIER BASE (THULE-MADE)

## Using (Installation) Instructions

Applicable model : MAZDA5 (CW)

Thank you very much for buying the Mazda Genuine Parts.

Before removal and installation, you are expected to carefully read these instructions.

To use it in its best conditions, be sure to read thoroughly these instructions for full understanding of the contents and to properly use it.

### <Cautions and Requests>

- ⚠ Caution and ⚠ Warning marks shown in these instructions indicate safety precautions, which you are requested to strictly comply with during installation and use.

**⚠ WARNING** : Indicates a situation in which serious injury or death could result if the warning is ignored.

**⚠ CAUTION** : Indicates a situation in which bodily injury or damage to the vehicle could result if the caution is ignored.

- Always avoid any installation and use that are not stated in these instructions.
- Do not ever alter the product when installing it.
- To ensure safety and reliability of the work, installation, removal and disposal work must be carried out by an Authorized Mazda Dealership.
- If you have any questions about the use of the product, ask your Mazda dealer for proper advice before using it.
- Mazda and its suppliers are not responsible for injuries, accidents, and damage to persons and property that arise from the failure of the dealer or installer to follow these instructions.
- Be careful not to lose removed parts, and be sure that they are kept free from scratches, grease or other dirt.

#### To the dealer

Please hand over these instructions to the customer after installation.

#### To the customer

- Keep these instructions after installation. The instructions may be necessary for installing other optional parts or removal of this accessory.
- Should the vehicle or this accessory be resold, always leave these instructions with it for the next owner.

1

## AS-COMPLETED VIEW

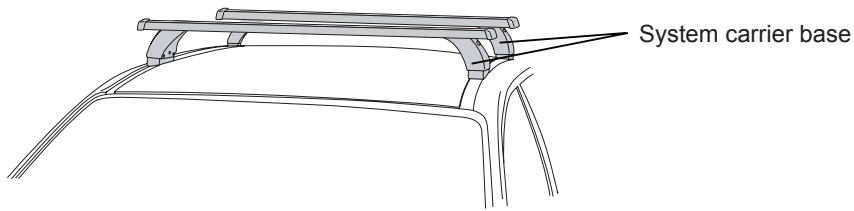

2

## TOOLS USED

Waste cloth (soft cloth)



Tape measure

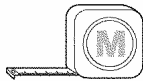

Scissors



Mild detergent  
(Car shampoo  
or equivalent)



3

## COMPONENTS

### ⚠ CAUTION

- Make sure that there is no missing component based on the following parts list and check the components for any dirt, scratches or other damage.
- If there's any missing parts or flawed parts, please contact your Mazda dealer.

No.	Part name	Q'ty	No.	Part name	Q'ty
①	Square bar (1080mm)	2	⑭	Mounting bolt (M6X65mm)	4
②	Foot base	4	⑮	Collar (For Fr, silver : 22mm)	2
③	Foot base cover	4	⑯	Collar (For Rr, blue : 20mm)	2
④	Bar end cap	4	⑰	Washer (dish-shaped)	4
⑤	Hexagon socket head bolt (M6X12mm)	8	⑱	Hexagon nut (M6)	8
⑥	Key cylinder	4	⑲	Flat spanner	2
⑦	Key	2	⑳	Locator seal	1
⑧	Hexagon wrench (5mm)	1	㉑	Wind noise prevention cover	2
⑨	Rubber pad 130 (Fr, RH)	1	㉒	Protect film	1
⑩	Rubber pad 129 (Fr, LH)	1	㉓	Carrier spoiler (100mm)	3
⑪	Rubber pad 132 (Rr, RH)	1	㉔	Carrier spoiler (200mm)	1
⑫	Rubber pad 131 (Rr, LH)	1	㉕	Maximum load label	1
⑬	Foot bracket	4	㉖	Spoiler locator seal	1
			㉗	Using (installation) instructions	1

NOTE: Contact Thule (1-800-238-2388) to order replacement keys.

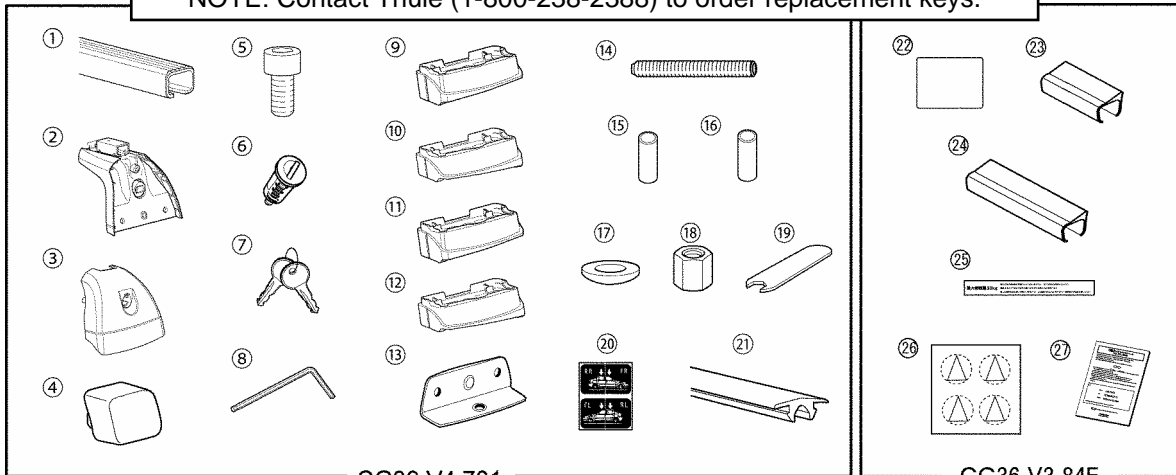

# 4

## PREPARATORY WORK BEFORE INSTALLATION



### CAUTION

- The contents in the caution boxes are more important points in installation. Be sure to use these cautions.
- The removal / installation work must be done by two or more personnel.

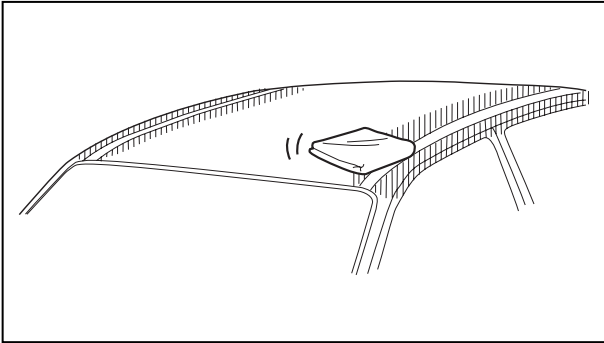

### Cleaning the attaching surface

1. Clean the roof and the moldings using a cloth soaked in mild detergent and then dry them completely.



### CAUTION

- Do not ever use an organic solvent such as thinner or benzene.

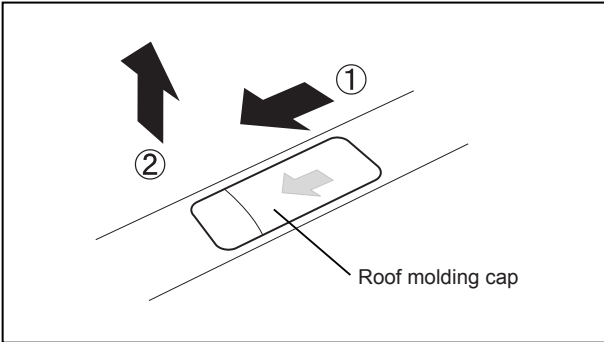

### Removing the roof molding cap

2. Slide the roof molding cap in the direction of the ① arrow and lift it up in the direction of the ② arrow to remove it.



### CAUTION

- The removed roof molding cap will be necessary after the carrier is removed. Be careful not to lose it.

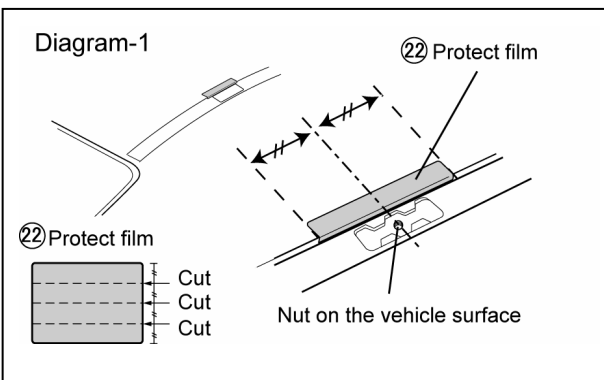

### Applying the protect film

1. Cut the ② protect film into quarters.
2. Put the ② protect films along the roof molding carrier. Align the ② protect films so that the nut is positioned in the center of the ② protect films as shown in the diagram 1. Also be sure to put the ② protect films so that they cover the edges of the both sides as shown in the diagram 2.

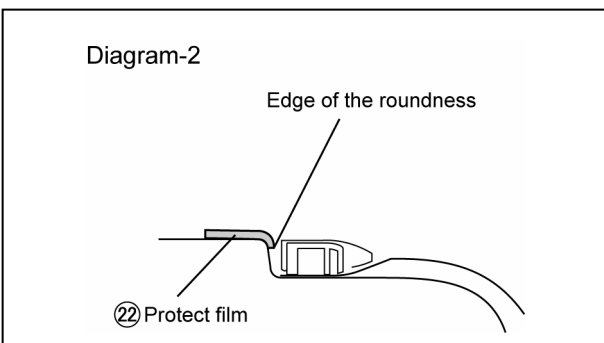

# 5

## ASSEMBLY OF THE CARRIER BASE

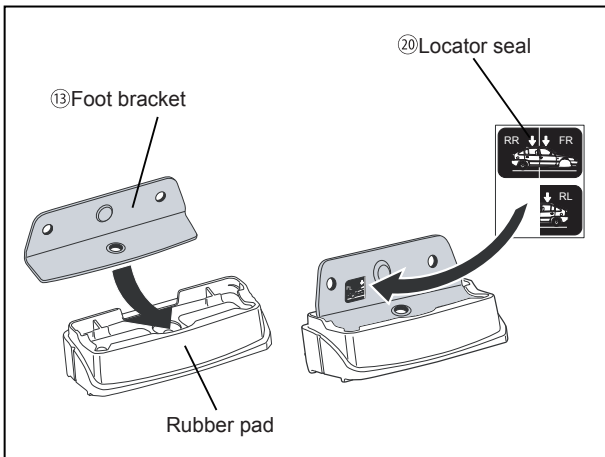
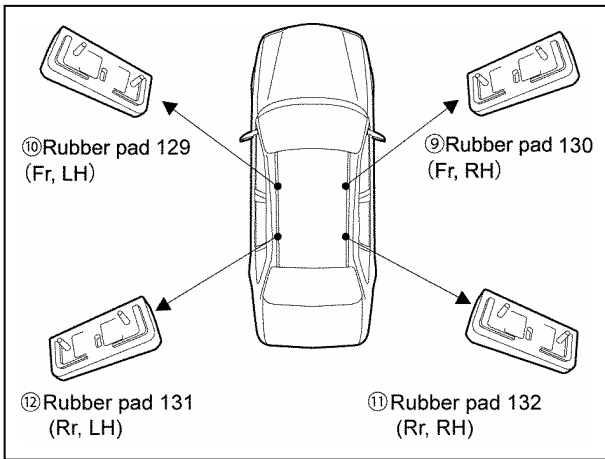
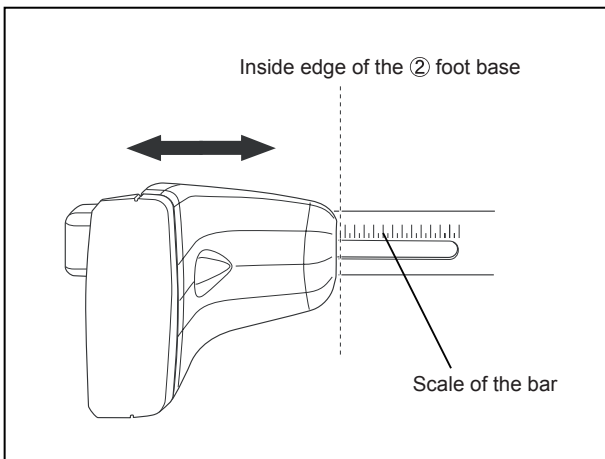
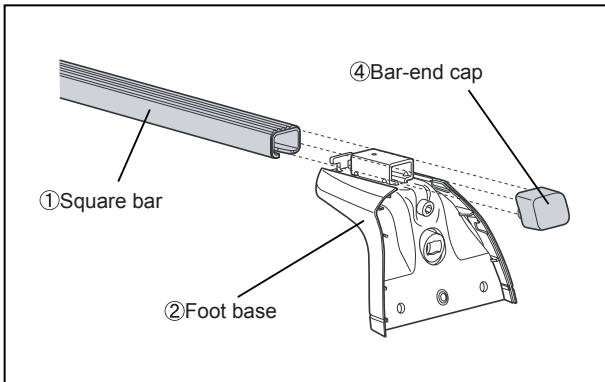

### Assembling the carrier base

1. Connect the ② foot base and the ④ bar end cap to the ① square bar.

2. Adjust the inside edge of the ② foot base to 17.0 (front) and 13.0 (rear) point on the scale of the ① square bar.



### CAUTION

- Tighten the nut with the associated ⑧ hexagon wrench as tight as it won't fall. The nut will be re-tightened later.

### Attaching the rubber pads

1. Confirm where the ⑨ ⑩ ⑪ and ⑫ rubber pads are to be located referring to the left diagram.

2. Attach the ⑨ ⑩ ⑪ and ⑫ rubber pads to each ⑬ foot bracket and then apply the ⑳ location seal to front-right, front-left, rear-right and rear-left brackets respectively.



### CAUTION

- Incused is the position where each rubber pad is to be placed and be sure to check it before the application.

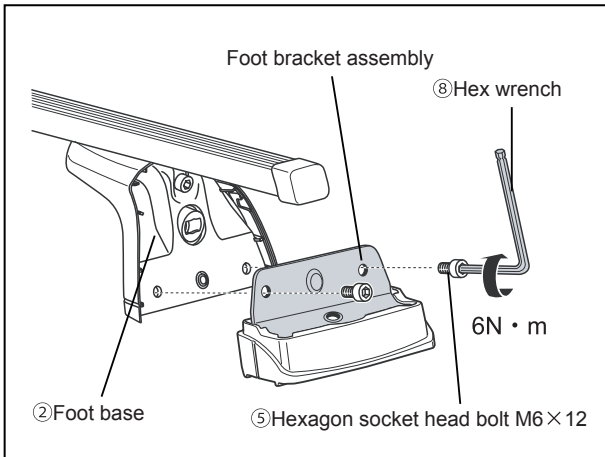

3. Install the foot bracket assembly to the ② foot base in combinations of FR and FL, RR and RL using the ⑤ hexagon socket head bolt (M6 × 12mm), then tighten and fix each foot bracket assembly using the ⑧ hexagon wrench.



### CAUTION

- Tightening torque for the bolt : About 6 N · m.

## 6

## INSTALLATION OF THE CARRIER BASE

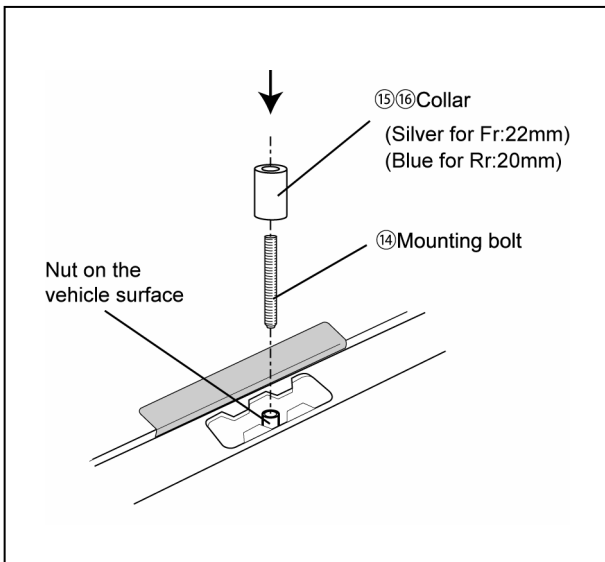

### Installing the carrier base

1. Completely fasten the ⑭ mounting bolt by hand to the nut on the vehicle surface, from there loosen it by one-half turn. Then attach the ⑮ and ⑯ collars.



### CAUTION

- Be careful not to confuse the front collars with rear ones. The silver ones are for front.

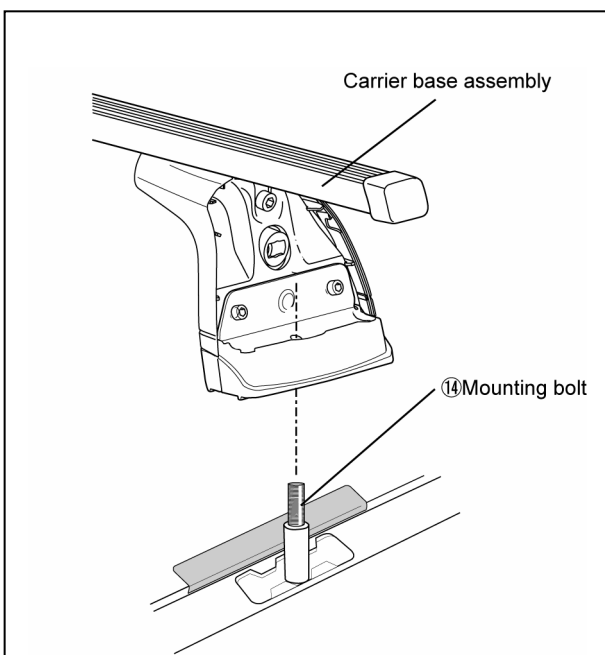

2. Attach the carrier base assembly to the ⑭ mounting bolt.

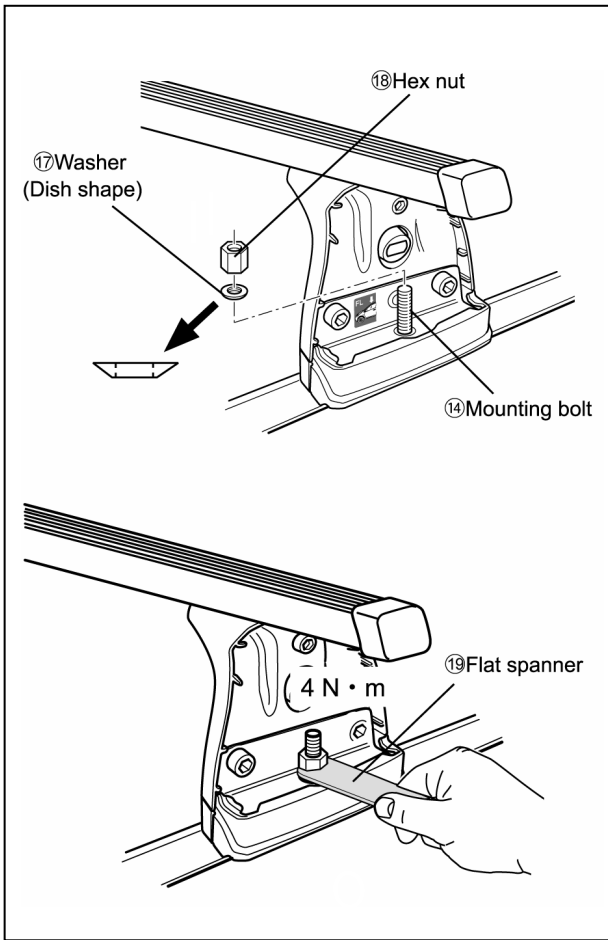

3. Mount the ⑰ washer (dish-shaped) and mount it as shown in the diagram, then tighten the ⑱ hexagon nut using the ⑲ flat spanner.

**CAUTION**

- Tightening torque for the nut : About 4 N·m

**CAUTION**

- Check the orientation of the ⑰ washer (dish-shaped).

**CAUTION**

- Tighten the ⑱ hexagon nuts on both sides equally.

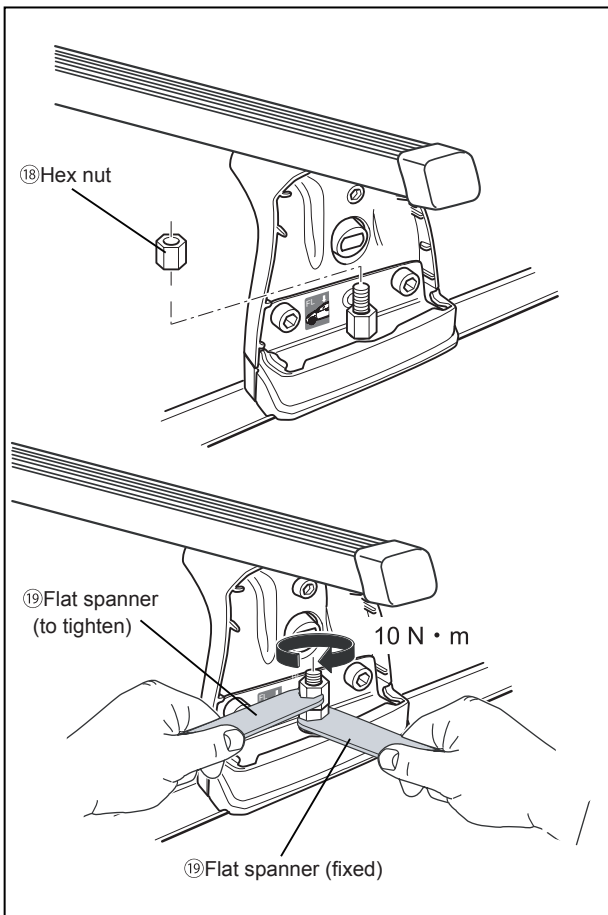

4. Install another ⑱ hexagon nut over the tightened ⑱ hexagon nut and use the ⑲ flat spanners as shown in the diagram : one is to fix the lower hexagon nut, another is to tighten the upper hexagon nut.

**CAUTION**

- Tightening torque for the nut : About 10 N·m

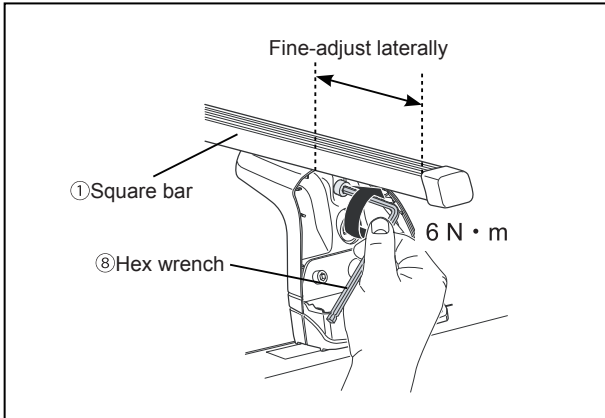

5. Make sure if the protrusions on the both ends of the ① square bar from the foot base are of equal length, then tighten the nut on the foot base using the ⑧ hexagon wrench.



### CAUTION

- Tightening torque for the nut : About 6 N · m

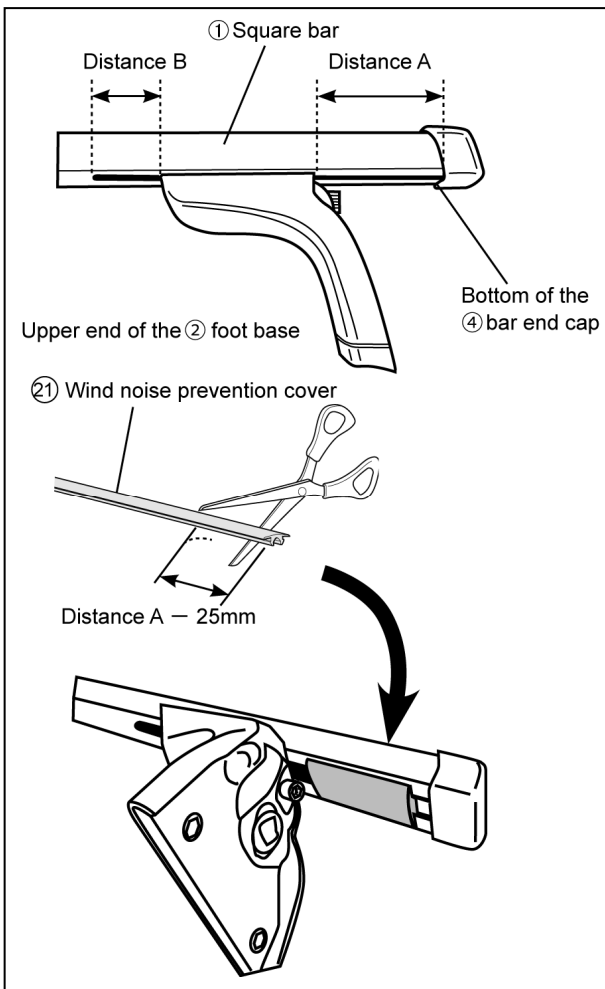

6. Measure the distance from the upper edge of the ② foot base and the bottom of the ④ bar end cap. Cut the ②① wind noise prevention cover to the length calculated by subtracting 25mm from the distance A. Then apply it to the groove on the back surface of the ① square bar. Cut the ②① wind noise prevention cover to the length of distance B, and cut the ②① wind noise prevention cover and apply it in the same manner as stated above.

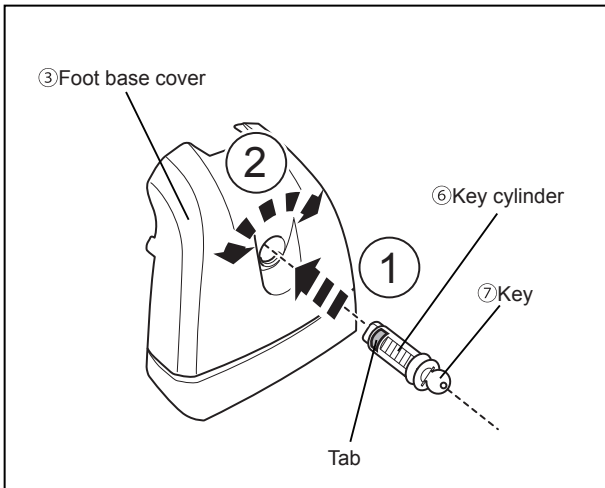

### Installing the key cylinders

1. With the ⑦ key inserted into the ⑥ key cylinder, insert the key cylinder deep into the attaching hole on the ③ foot base cover with its tab pointing upper left, turn it until the key is turned into a horizontal position.

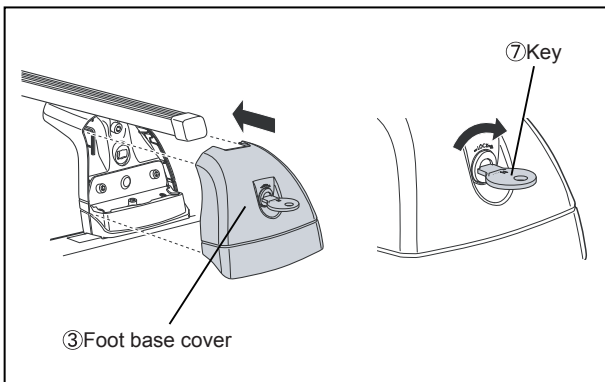

### Installing the foot base covers

1. Install the ③ foot base cover and turn the ⑦ key until it is turned into a vertical position, then take out the key.

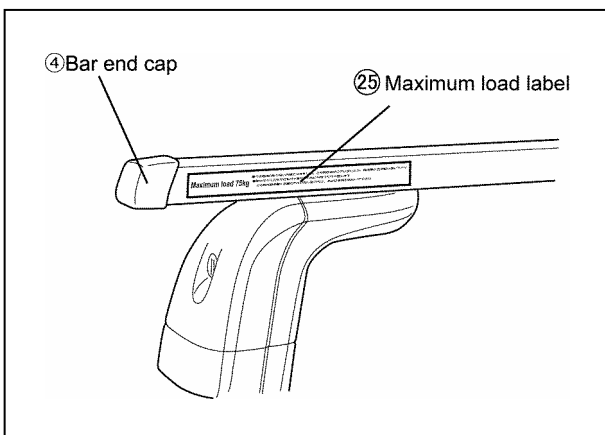

### Applying the maximum load label

1. Put the ②⑤ maximum load label on the end of the ④ bar end cap on the front and rear carrier bar on the driver's seat side.



Front side

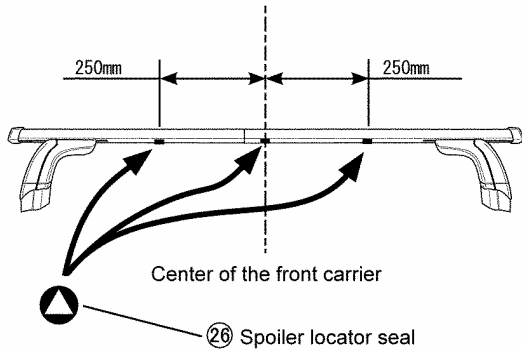

Rear side

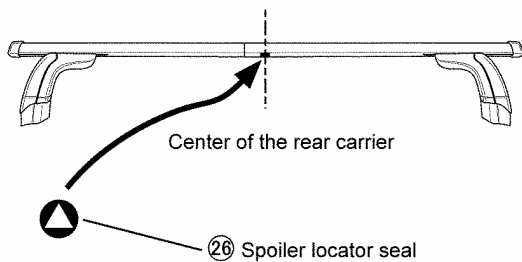

## Installing the carrier spoilers

### NOTE

- When the vehicle is running only with the base carrier installed, wind noise may occur. It is necessary to install the ⑳, ㉔ carrier spoilers to prevent the noise. Also it is necessary to uninstall the ⑳, ㉔ carrier spoilers when installing any other attachments.

1. Put the ㉖ spoiler locator seal (three places) on the designated locations on the front carrier bar's under surface as shown in the diagram.
2. Put the ㉖ spoiler locator seal (one place) on the designated locations on the rear carrier bar's under surface as shown in the diagram.
3. Align the ㉓, ㉔ carrier spoilers with the ㉖ locator seals as shown in the diagram and then attach them.

Front side

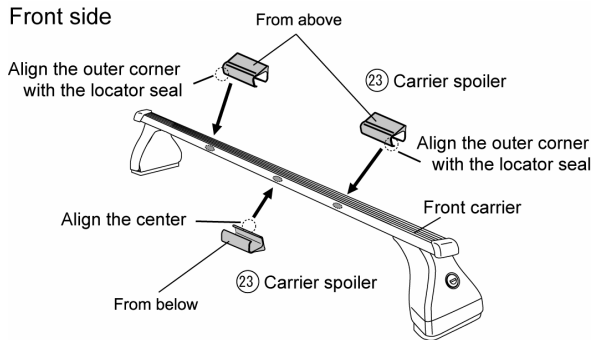

Rear side

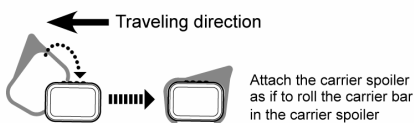
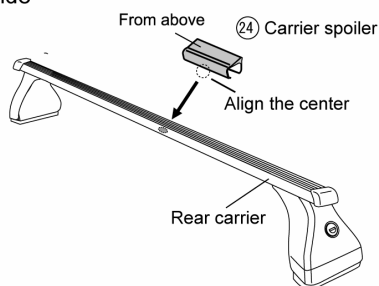

### CAUTION

- Check direction of the ㉓, ㉔ carrier spoilers.

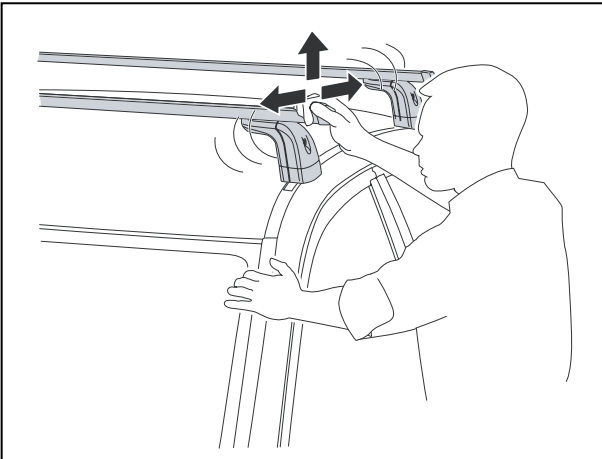
**7****CHECK AFTER INSTALLATION**

1. Check if each system carrier is fixed securely by shaking it side to side and up and down. If the system carrier is shaky or movable, check again if the system carriers have been installed according to this instructions especially regarding its location, method and tightening.

**8****HANDLING INSTRUCTIONS AND PRECAUTIONS**

**Be sure to read thoroughly and comply with the following precautions for your safety.**

**1. Prior-to-drive cautions****WARNING**

- The carrier base is not designed to bear a load by itself. Purchase an appropriate genuine attachment (sold separately) depending on the loadage and use the carrier base with it.
- The maximum load capacity is 75kg (including the weight of the carrier base and any other attachments). Do not overload.
- As for the vehicles with sun roof, the sun roof does not tilt or slide when any genuine attachment is attached to the carrier base. Be careful not to try too hard to tilt or slide it, or breakage may occur.
- Regarding load limits, follow laws and regulations.
- Initial instability may happen, be sure to re-tighten the bolts and nuts. Check for loose bolts and nuts regularly (about every 100 km travel).
- When a lengthy object such as a ski or a mast is on the carrier base, be careful not to hit the back door against the load in opening it.

## 2. Precautions for driving



### WARNING

- Avoid sudden braking and steering when the system carrier base is installed. The load may fall and accident may occur.
- Operation characteristics may vary significantly depending on road (curve or rough road) and weather conditions (strong crosswind / headwind, rain, snow or fog) when the carrier is installed. Avoid driving at high speed and always drive slow enough to be able to handle the unexpected situations.
- Be sure to check if the total height of the vehicle is within the limit before going into a tunnel or a multilevel parking garage.

## 3. Precautions for washing

- Avoid using automatic car washing machine when the system base carrier is installed. Otherwise the system carrier (base) or the vehicle roof may get damaged. Uninstall the system carrier base whenever using automatic car washing machine. Or hand-wash the vehicle when the system carrier base cannot be uninstalled.

# 9

## REMOVAL PROCEDURE AND STORAGE



### WARNING

- Be careful not to lose the removed parts.
- The removal work must be done by two or more personnel in order to prevent damage to the vehicle and the system carrier (base).
- Be sure to clean the system carrier (base) before storing it and always store it in a dry place.
- Never lose the attachments and the installation (using) instructions.

### 1. Removal

- (1) Unload all goods from the attachment.
- (2) Remove all the attachments. Refer to the instructions of each attachment for removal procedures. Uninstall the ③ foot base cover in the reverse order of “6 INSTALLATION OF THE CARRIER BASE”, then loosen the ⑱ hexagon nuts to uninstall each component.
- (3) Detach the system carrier base from the vehicle.

### 2. Record the key number

Be sure to record the key No. in case of losing the key.



Key number  
No.



### WARNING

- When reinstalling the carrier base, make sure if there's no missing and damaged parts, and be sure to follow this manual.

If you have any questions about the product, please contact your Mazda dealer for proper advice.

# Installation inspection sheet

[To be used by installation workshop]

MAZDA5	SYSTEM CARRIER BASE
--------	---------------------

## Inspection items after installation

- Inspect the installed parts and removed and re-installed parts following the items below.

Section to be inspected	Inspection item (circle)			
	Gap, fit & finish	Scratch, stain tape residue	Tightening & engagement	Operation check
Foot		○	○	
Carrier bar		○	○	
Protect sheet		○	○	
Key		○	○	○
Doors	○	○	○	○

## System carrier base installation inspection

Date (year/month/day):					
VIN No.					
Approved		Checked		Prepared	

※ Retention period of the sheet : 36 months